

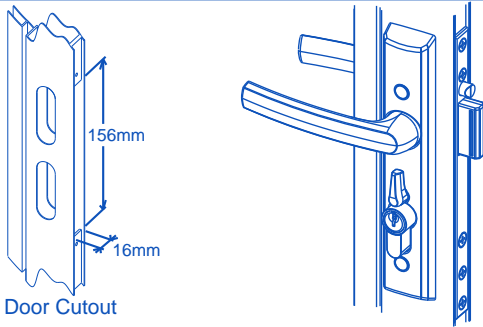

# ELEGANCE

for hinged security doors

## ILLUSTRATED FITTING INSTRUCTIONS



### 1.

### Preparation

- 1 The **sticker** on the rear of the **lockbody** is to assist in easy installation. - **Do not remove.**
- 2 If the **sticker** has been broken or removed, ensure that the **rear slide** is pushed completely down before assembling the **lockbody** into the **door cutout**.

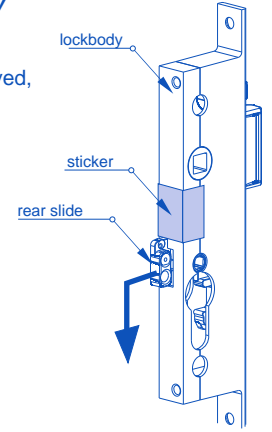

### 2.

### Lockbody Installation

- 1 Insert the **lock body** into the **door cutout**
- 2 Secure the **lockbody** with the two **#8x13mm lockbody screws**.

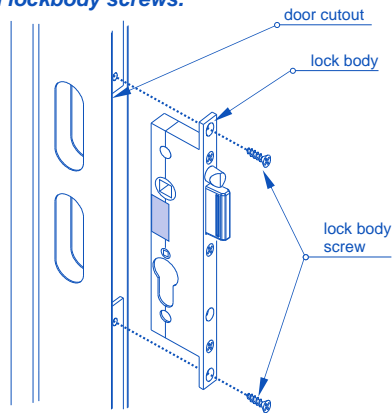

**IMPORTANT :** If installing ELEGANCE with a multipoint accessory kit, be sure to follow the cylinder installation procedure within the multipoint kit instructions.

### 3.

### Cylinder installation

- 1 Depress the **auxiliary bolt** to ensure the **main bolt** is fully extended.
- 2 Assemble the **cylinder** through the lock so the **cylinder** protrudes equally from both sides.  
**NOTE :** the cylinder **cam** must rotate as shown below. (cam turns towards front of door)
- 3 Insert the **key** and turn to locked position.
- 4 Insert **#10 x 38mm cylinder screw** & tighten.  
**NOTE :** test, **main bolt** should not depress
- 5 Turn **key** to unlocked position and remove **key**.

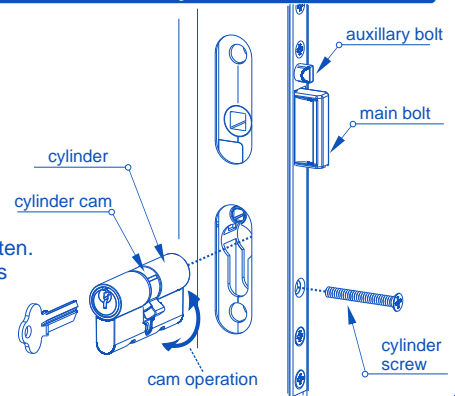

**Note: If NOT using the 'Caretaker' feature - go to Step 6.**

### 4.

### 'Caretaker' feature

- 1 Select the **exterior handle assembly** which includes the caretaker mechanism shown below.
- 2 When viewing the door from the outside of the house, if the hinges are on the right hand side, rotate the 'D' pin towards the right hand marks - RH. As shown below. If the door hinges are on the left hand side, rotate the 'D' pin towards the left hand marks - LH. As shown below.

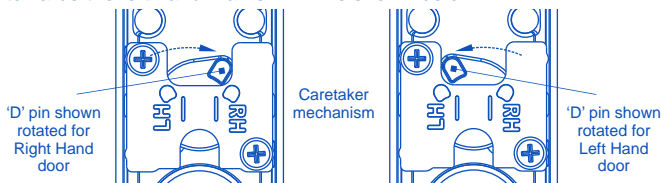

### 5.

### 'Caretaker' feature

- 1 Slide the Caretaker spindle vertically under the caretaker cover plate as shown below.
- 2 Go to step 7

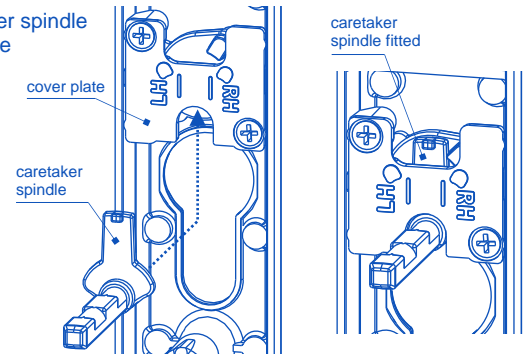

### 6.

### 'Caretaker' feature

- 1 If **not** using the 'caretaker' feature, push the plastic plug which has the Austral logo, into the square hole shown below.
- 2 Move the 'D' pin until the Austral logo on the plastic plug is vertical.
- 3 After adjusting, give the plug a final push to insure it is tight.

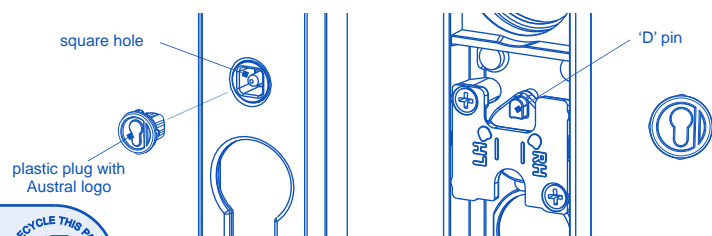

### 7.

### Fit the correct Snib Lever

- 1 Select the **interior handle assembly** with **snib lever hole**.
- 2 Select the correct snib lever as shown in the box below.
- 3 Hold the **snib lever** horizontally and insert it into the **snib lever hole**, turn it until vertical to secure it.
- 4 If the **handle** does not point towards the door hinges, remove it from the **handle plate** and exchange with the other **handle**.
- 5 While holding the **snib lever** vertical, place the lever assembly against the door.

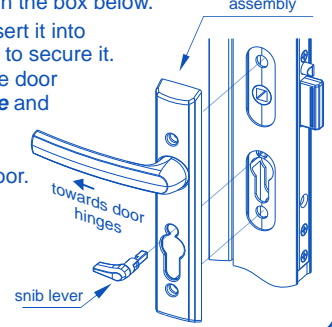
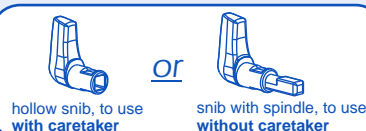

PLEASE TURN PAGE FOR INSTALLATION STEPS 8, 9 & 10

## 8. Install the furniture

- 1 Insert the **handle rod** through the **lock body**.
- 2 Locate the **exterior handle assembly** over the **lock body**.
- 3 Fit the two **#8x32mm furniture screws**.

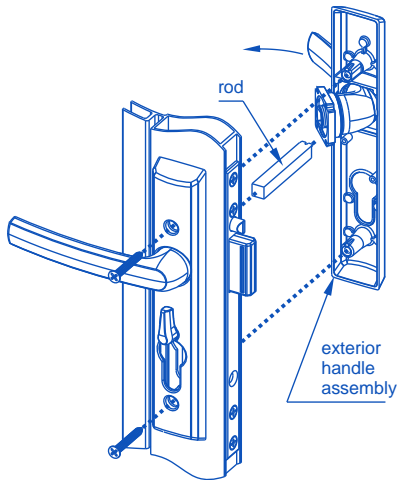

## 9. Strike Plate Positioning

- 1 Pencil mark the **door jamb** at the same height as the **main bolt**. (refer to indicator lines below)
- 2 Center the **strike plate's square cutout** over the pencil marks on the **door jamb**.
- 3 Pencil mark the **door jamb** through the **screw holes** and the **square cutout**.
- 4 Pilot drill the **screw holes** if necessary.

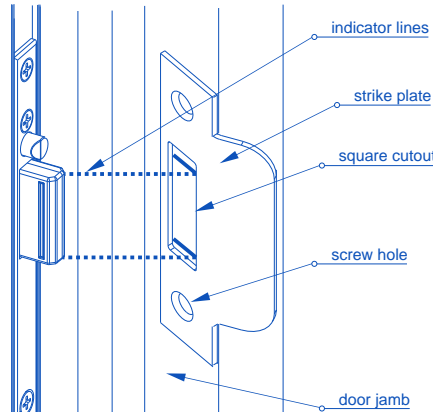

## 10. Strike Plate Installation

- 1 Remove the timber inside the marked square with a chisel to a **depth of 16mm** to ensure there is adequate clearance around all sides of the **main bolt**.
- 2 Secure the **strike plate** to the **door jamb** with two **#8x25mm screws**.
- 3 Test the lock. If the lock will not operate, remove more timber.

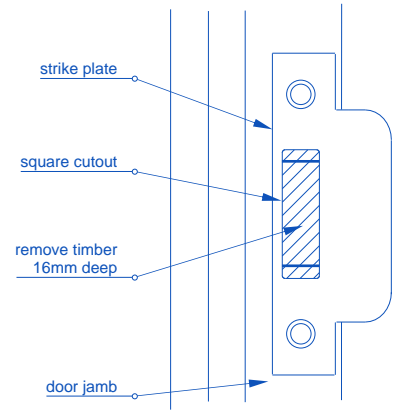

## Elegance - CARE & MAINTENANCE

### Installation

The product must be installed according to the instructions included in the product packaging and the door should be apertured according to the door "cut-out" dimensions and tolerances shown.

Prior to fitting ensure that:

- Doors stored on site are stored in a clean dry area free from cement, lime, paint, acid etc.

During fitting of the lock ensure that :

- No metal swarf or other contaminants enter the lock body.
- The fixing screws do not damage the product finish.

After installation of the door ensure that:

- The door is correctly adjusted with the correct clearances.
- The lock engages the strike plate correctly.
- The door is protected from building fall-out such as wet plaster, mortar, paint and welding splatter.

If the door becomes contaminated:

- Do not paint the lock body or faceplate.
- Remove wet plaster, cement, mortar and other droppings immediately, using ample clean water and a sponge or rag, to avoid permanent staining or scratching of the product finish. If removal is delayed and scraping becomes necessary the surface finish may suffer.

### Maintenance

Annually inspect the door to confirm that the door operates with the correct clearances, closes and opens without obstruction and confirm that the lock tongue slides easily up the strike plate wing to freely enter the strike plate aperture when the door is closed - adjust the door if necessary.

Annually check that when the door is closed, the lock can be locked by key and by the snib lever.

Quarterly wipe the strike plates with a soapy rag to remove built up debris and to lubricate the strike plate (To prevent bouncing of the door).

NB : The lock assembly has been lubricated for life, and should not be disassembled by the user.

### Cleaning Powder Coatings

Every six months, powder coated surfaces should be cleaned to protect the finish. However, in areas where pollutants are more prevalent, especially in coastal or industrial regions, cleaning should be carried out every two to three months.

To clean the powder coated surface:

1. Carefully remove any loose deposits with a wet sponge.
2. Use a soft brush (non abrasive) or cloth and a mild household detergent solution to remove dust, salt and other deposits. Do not use steel wool, scrapers, scouring liquids or powders to remove deposits as these permanently scratch the coating surface.
3. Rinse off with clean fresh water.

### Cleaning Chrome, Satin Chrome, Gold and Brass Finishes

Plated finishes are susceptible to tarnishing if they come into contact with moisture, wet paint, or water vapour. All plated finishes should be coated with a non-abrasive furniture or car wax immediately after installation. Plated finishes should be regularly wiped with a non-abrasive furniture or car wax, taking care not to scratch any protective finishes that are employed to protect the surface and prevent tarnishing.

## Elegance - MAINTENANCE LOG

In order to protect your warranty, record all maintenance activity in the following log:

<b>Address of Building :</b>		
<b>Name of Door:</b>		
<b>Date</b>	<b>Activity</b>	<b>Signed</b>



Austral Lock

42 Export Dr, Brooklyn  
Victoria 3012 Australia  
ph (+61 3) 9314 1077  
fax (+61 3) 9314 2400  
[www.ausloc.com](http://www.ausloc.com)

A division of  
**GAINSBOROUGH**  
Hardware Industries Limited